





TC Steep Taper Toolholders

5

DIN 69871

ER *SYSTEM*

- 5.1 **Features | Benefits**
- 5.2 **Information**
- 5.4 **TC | ER | ERA**
- 5.6 **TC | ER**

powRgrip *SYSTEM*

- 5.7 **Features | Benefits**
- 5.8 **Information**
- 5.10 **TC | PG**

Other Toolholders

- 5.11 **TC | WD End Mill Holders WELDON**
- 5.12 **TC | KFD
Universal Shell Mill / Face Mill Holders**
- 5.13 **TC | KBF Drill Chucks**
- 5.14 **TC | MK Morse Taper Holders**

Tapping holders for use with appropriate Weldon toolholders
see page 9.14/9.16 for ER and 9.22/9.24 for powRgrip®.



Swiss
Precision
Tools

ER

Toolholders

Features | Benefits

Swiss Quality

Made in Switzerland to ISO 9001/ISO 14001.

1 Marking

Type and part number.

2 Traceability

Lot number marking on all products for traceability through the entire manufacturing process.

3 Original REGO-FIX®

Our extensive experience results in a well-engineered system. Original only with the REGO-FIX® quality seal \triangle .

T.I.R. <3 μ m

Inner diameter to outer diameter.

Taper Accuracy AT3

Better spindle-to-holder fit and accuracy.

Surface Finish max. Ra 0.25

Higher clamping force and higher transferable torque.

Q+® Balancing

100% balanced to G 2.5 @ 22'000 min⁻¹.

Hi-Q® Balancing System

Ready to accept Hi-Q® balancing rings which allow to offset the imbalance introduced by the cutting tool up to 80'000 min⁻¹.

Hi-Q® Clamping Nut Included

Guarantees highest clamping force and best balancing.

Vibration Dampening

For best machining results.

ID Chip Hole

Per DIN 69873 with 10 mm diameter.

5

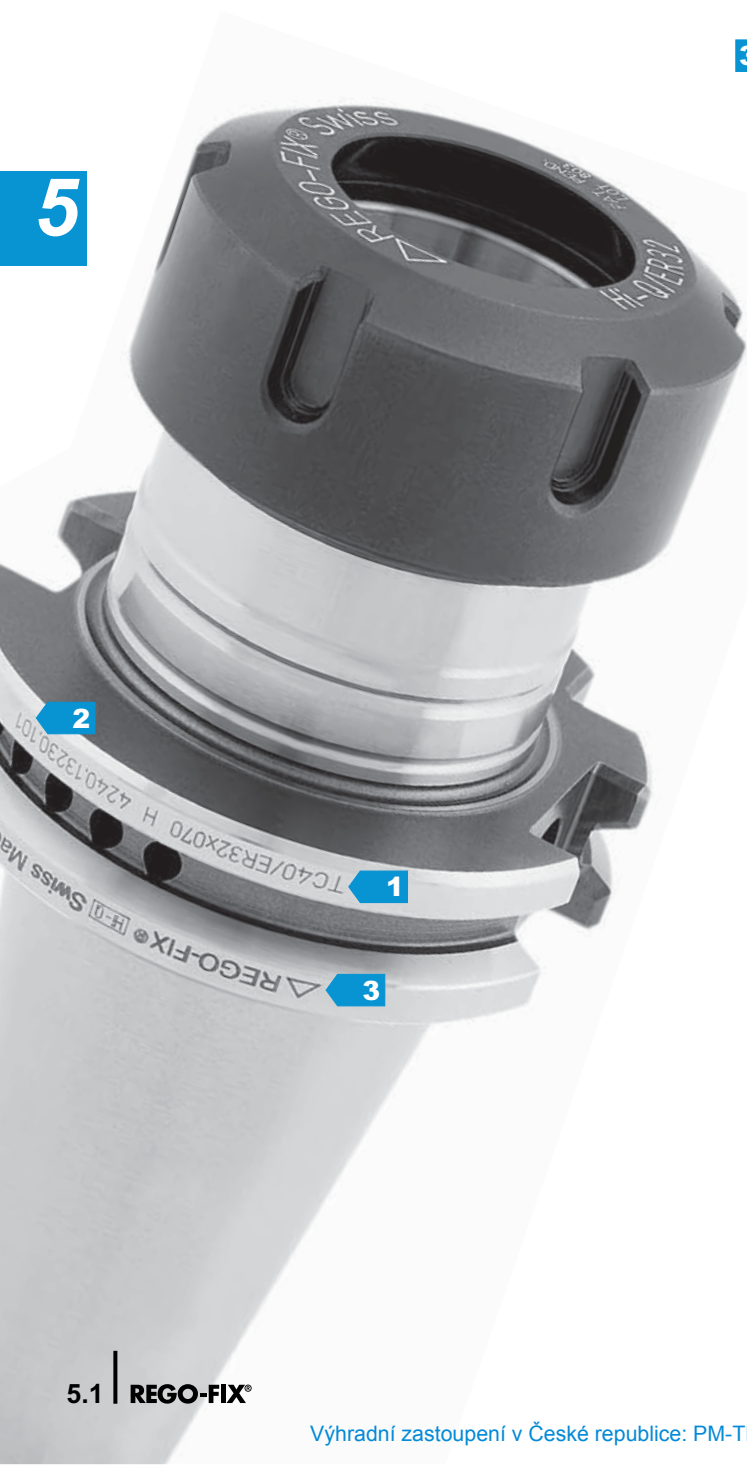

TC/ER Toolholder

Applications

These collets are designed for use on CNC-machining centers with automatic tool changer. They are universally suitable for drilling, machining, reaming, tapping and grinding. The vibration dampening of these systems reduce spindle wear and extend tool life.

Balancing

REGO-FIX® Q+® System TC/ER collets are balanced to G 2.5 @ 22'000 min⁻¹. Type H collets are ready to accept Hi-Q® balancing rings which allow precision balancing of the system including cutting tool up to 80'000 min⁻¹ depending on the balancing rings used.

Special Applications

When extra high clamping force is needed, e.g. when tapping with ER-GB or ET1*, we recommend to use of our friction bearing clamping nuts Hi-Q®/ERB and Hi-Q®/ERBC.

*Not for coolant through tools and not for applications with sealing disks.

Matched Tooling System for Best Fit

For highest precision and best results the whole system counts. Therefore REGO-FIX® components are carefully matched for optimum fit and accuracy. This guarantees the best run-out and balance.

For the influence of run-out on tool life see the graph page 2.3.

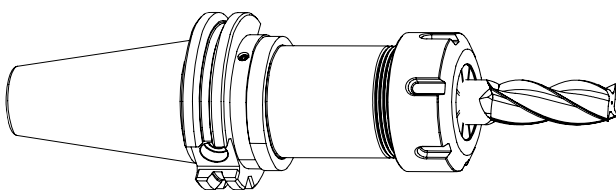

TC/ERA Toolholder

Applications

These collets are specially designed for mill-turning machines, multitasking machines and small vertical machining centers. They have the well known REGO-FIX surface finish, precision and thanks to their shortness a superior stiffness. ERA Zero-Z® toolholders have the shortest possible projection to increase the Z-axis travel of the machine and to allow larger work-pieces to be machined.

Balancing

REGO-FIX® Q+® System TC/ERA collets are balanced to G 2.5 @ 22'000 min⁻¹.

Special Features

Thanks to the built in Hi-Q®/ERAX clamping nut the transferable torque is extremely high. This clamping nut has been specially designed for applications where space is at a premium. Slippage off of the wrench is prevented by a patented design.

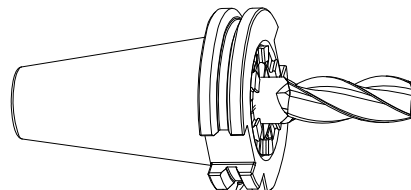

! We recommend tightening the clamping nuts with a torque wrench. The maximum torque shall not be more than 25% above the recommended tightening torque.

Recommended tightening torque see page 13.3/13.4.



Swiss
Precision
Tools

ER

Toolholders

Matching Products

Clamping Nuts | Collets | Spanners

5

Clamping Nut and Spanner	ER 11	ER 16	ER 20	ER 25	ER 32	ER 40	ER 50	Page	Standard	With Friction Bearing	Balanced	For Coolant Through Tools	Collet Locking System	Mini-Nut	Nut with External Thread	Spanner
Hi-Q/ER	3411.00000	3416.00000	3420.00000	3425.00000	3432.00000	3440.00000	-	4.4	■		■		■			
Hi-Q/ERC	3411.20300- 3411.20700	3416.20000	3420.20000	3425.20000	3432.20000	3440.20000	-	4.6 4.8			■	■	■			
Hi-Q/ERB	-	3416.30000	3420.30000	3425.30000	3432.30000	3440.30000	-	4.10		■	■		■			
Hi-Q/ERBC	-	3416.40000	3420.40000	3425.40000	3432.40000	3440.40000	-	4.10		■	■	■	■			
EP	7112.11010	7112.16010	7112.20010	-	-	-	-	12.1								■
E	-	-	-	7111.25000	7111.32000	7111.40000	-	12.1								■
Hi-Q/ERAX	-	-	3320.60000	-	3332.60000	-	-	4.18			■		■		■	
Hi-Q/ERAXC	-	-	3320.70000	-	3332.70000	-	-	4.18			■	■	■		■	
EAX	-	-	7117.20000	-	7117.32000	-	-	12.2								■

Recommended tightening torque on page 13.3/13.4.

Collet	ER 11/ET1-12		ER 16/ET1-16		ER 20/ET1-20		ER 25/ET1-25		ER 32/ET1-32		ER 40/ET1-40		ER 50	
	Clamping Range [mm]	Page	Clamping Range [mm]	Page	Clamping Range [mm]	Page	Clamping Range [mm]	Page	Clamping Range [mm]	Page	Clamping Range [mm]	Page	Clamping Range [mm]	Page
ER	0.5–7.0	2.8	0.5–10.0	2.10	0.5–13.0	2.12	0.5–16.0	2.14	1.0–20.0	2.16	2.0–30.0	2.18	–	–
ER-UP	0.5–7.0	2.8	0.5–10.0	2.10	0.5–13.0	2.12	0.5–16.0	2.14	1.0–20.0	2.16	2.0–30.0	2.18	–	–
ER-DM	2.75–7.0	2.22	3.0–10.0	2.24	3.0–10.0	2.26	6.0–16.0	2.28	6.0–20.0	2.30	6.0–26.0	2.32	–	–
ER-MB	0.2–0.9	2.8	0.2–0.9	2.10	–	–	–	–	–	–	–	–	–	–
ER-GB	2.8–6.0	3.4	4.0–9.0	3.4	4.0–11.2	3.4	4.0–16.0	3.4	4.0–20.0	3.4	6.0–22.0	3.4	–	–
ET 1*	1.4–3.55	3.8	1.4–6.3	3.8	2.2–7.0	3.8	2.5–10.0	3.8	4.5–12.5	3.8	6.0–17.0	3.8	–	–

*Not for coolant through tools and not for applications with sealing disks.

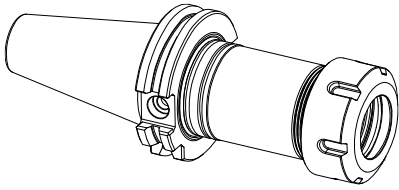

ER Colletholders | ERA Zero-Z® Colletholders | Balancing Rings

Type	Form A+AD Part No.	Form AD+B Part No.	D [mm]	L [mm]	Balancing Rings
TC 30 / ER 16 x 070 H	4230.11630	4230.11633	28	70	FWR 285
TC 30 / ER 16 x 100 H	4230.11650	4230.11653	28	100	FWR 285
TC 30 / ER 25 x 060 H	4230.12520	4230.12523	42	60	FWR 325
TC 30 / ER 32 x 065*	2230.13220	2230.13223	50	65	-

TC 40 / ER 11 x 100 H	4240.11150	4240.11153	19	100	FWR 325
TC 40 / ER 11 x 160 H	4240.11180	4240.11183	19	160	FWR 325
TC 40 / ER 16 x 070 H	4240.11630	4240.11633	28	70	FWR 405
TC 40 / ER 16 x 100 H	4240.11650	4240.11653	28	100	FWR 405
TC 40 / ER 16 x 160 H	4240.11680	4240.11683	28	160	FWR 405/225
TC 40 / ER 16 x 200 H	4240.11690	4240.11693	28	200	FWR 405/225
TC 40 / ER 20 x 070 H	4240.12030	4240.12033	34	70	FWR 325
TC 40 / ER 20 x 100 H	4240.12050	4240.12053	34	100	FWR 325
TC 40 / ER 25 x 070 H	4240.12530	4240.12533	42	70	FWR 405
TC 40 / ER 25 x 100 H	4240.12550	4240.12553	42	100	FWR 405
TC 40 / ER 25 x 160 H	4240.12580	4240.12583	42	160	FWR 405/325
TC 40 / ER 25 x 200 H	4240.12590	4240.12593	42	200	FWR 405/325
TC 40 / ERA 32 x 019*	2240.13207	-	-	19	-
TC 40 / ER 32 x 070 H	4240.13230	4240.13233	50	70	FWR 405
TC 40 / ER 32 x 100 H	4240.13250	4240.13253	50	100	FWR 405
TC 40 / ER 32 x 160 H	4240.13280	4240.13283	50	160	FWR 405/405
TC 40 / ER 32 x 200 H	4240.13290	4240.13293	50	200	FWR 405/405
TC 40 / ER 40 x 080*	2240.14040	2240.14043	63	80	-
TC 40 / ER 40 x 100 H	4240.14050	4240.14053	63	100	FWR 505
TC 40 / ER 40 x 160 H	4240.14080	4240.14083	63	160	FWR 505/505

ERA

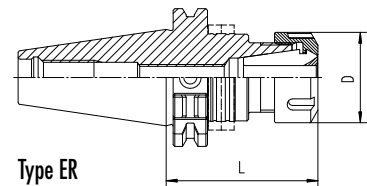

Type ER
Form A+AD

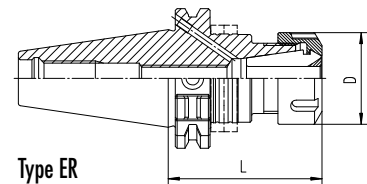

Type ER
Form AD+B

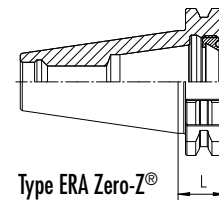

Type ERA Zero-Z®
Form A+AD

5

Hi-Q® Balancing Rings	Part No.	Page
Set FWR 225	7490.22500	12.9
Set FWR 285	7490.28500	12.9
Set FWR 325	7490.32500	12.9
Set FWR 405	7490.40500	12.9
Set FWR 505	7490.50500	12.9
Torque screwdriver (TSD)	7159.09000	12.9

Maximum rpm for Hi-Q balancing rings see page 12.9.

Drawings with detailed dimensions see

search.rego-fix.ch



Swiss
Precision
Tools

ER

Toolholders

Matching Products

Clamping Nuts | Collets | Spanners

5

Clamping Nut and Spanner	ER 11	ER 16	ER 20	ER 25	ER 32	ER 40	ER 50	Page	Standard	With Friction Bearing	Balanced	For Coolant Through Tools	Collet Locking System	Mini-Nut	Nut with External Thread	Spanner
Hi-Q/ER	-	3416.00000	3420.00000	3425.00000	3432.00000	3440.00000	3450.00000	4.4	■		■		■			
Hi-Q/ERC	-	3416.20000	3420.20000	3425.20000	3432.20000	3440.20000	-	4.8			■	■	■			
Hi-Q/ERB	-	3416.30000	3420.30000	3425.30000	3432.30000	3440.30000	3450.30000	4.10		■	■		■			
Hi-Q/ERBC	-	3416.40000	3420.40000	3425.40000	3432.40000	3440.40000	-	4.10		■	■	■	■			
EP	-	7112.16010	7112.20010	-	-	-	-	12.1								■
E	-	-	-	7111.25000	7111.32000	7111.40000	7111.50000	12.1								■

Recommended tightening torque on page 13.3/13.4.

Collet	ER 11/ET1-12		ER 16/ET1-16		ER 20/ET1-20		ER 25/ET1-25		ER 32/ET1-32		ER 40/ET1-40		ER 50	
	Clamping Range [mm]	Page	Clamping Range [mm]	Page	Clamping Range [mm]	Page	Clamping Range [mm]	Page	Clamping Range [mm]	Page	Clamping Range [mm]	Page	Clamping Range [mm]	Page
ER	-	-	0.5–10.0	2.10	0.5–13.0	2.12	0.5–16.0	2.14	1.0–20.0	2.16	2.0–30.0	2.18	4.0–34.0	2.18
ER-UP	-	-	0.5–10.0	2.10	0.5–13.0	2.12	0.5–16.0	2.14	1.0–20.0	2.16	2.0–30.0	2.18	4.0–34.0	2.18
ER-DM	-	-	3.0–10.0	2.24	3.0–10.0	2.26	6.0–16.0	2.28	6.0–20.0	2.30	6.0–26.0	2.32	-	-
ER-MB	-	-	0.2–0.9	2.10	-	-	-	-	-	-	-	-	-	-
ER-GB	-	-	4.0–9.0	3.4	4.0–11.2	3.4	4.0–16.0	3.4	4.0–20.0	3.4	6.0–22.0	3.4	22.0–32.0	3.4
ET 1*	-	-	1.4–6.3	3.8	2.2–7.0	3.8	2.5–10.0	3.8	4.5–12.5	3.8	6.0–17.0	3.8	-	-

*Not for coolant through tools and not for applications with sealing disks.

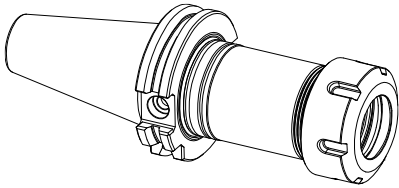

ER Colletholders | ERA Zero-Z® Colletholders | Balancing Rings

Type	Form A+AD Part No.	Form AD+B Part No.	D [mm]	L [mm]	Balancing Rings
TC 50 / ER 16 x 100 H	4250.11650	4250.11653	28	100	FWR 505
TC 50 / ER 16 x 160 H	4250.11680	4250.11683	28	160	FWR 505/225
TC 50 / ER 16 x 200 H	4250.11690	4250.11693	28	200	FWR 505/225
TC 50 / ER 20 x 070 H	4250.12030	4250.12033	34	70	FWR 325
TC 50 / ER 20 x 100 H	4250.12050	4250.12053	34	100	FWR 325
TC 50 / ER 25 x 070 H	4250.12530	4250.12533	42	70	FWR 405
TC 50 / ER 25 x 100 H	4250.12550	4250.12553	42	100	FWR 405
TC 50 / ER 25 x 160 H	4250.12580	4250.12583	42	160	FWR 405/325
TC 50 / ER 25 x 200 H	4250.12590	4250.12593	42	200	FWR 405/325
TC 50 / ER 32 x 100 H	4250.13250	4250.13253	50	100	FWR 505
TC 50 / ER 32 x 160 H	4250.13280	4250.13283	50	160	FWR 505/405
TC 50 / ER 32 x 200 H	4250.13290	4250.13293	50	200	FWR 505/405
TC 50 / ER 40 x 100 H	4250.14050	4250.14053	63	100	FWR 505
TC 50 / ER 40 x 160 H	4250.14080	4250.14083	63	160	FWR 505/505
TC 50 / ER 40 x 200 H	4250.14090	4250.14093	63	200	FWR 505/505
TC 50 / ER 50 x 100*	2250.15050	-	78	100	-

Supplied with: ER colletholder with Hi-Q® clamping nut, ERA colletholder with Hi-Q® AX clamping nut.
*Not for use with balancing rings.

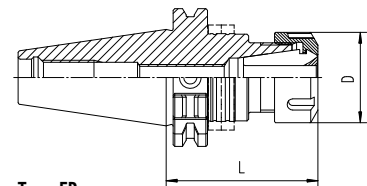

Type ER
Form A+AD

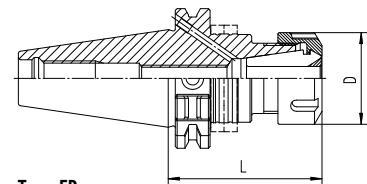

Type ER
Form AD+B

5

Hi-Q® Balancing Rings	Part No.	Page
Set FWR 225	7490.22500	12.9
Set FWR 285	7490.28500	12.9
Set FWR 325	7490.32500	12.9
Set FWR 405	7490.40500	12.9
Set FWR 505	7490.50500	12.9
Torque screwdriver (TSD)	7159.09000	12.9

Maximum rpm for Hi-Q balancing rings see page 12.9.

Drawings with detailed dimensions see

search.rego-fix.ch



Swiss
Precision
Tools

PG

powRgrip® Toolholders

Features | Benefits

Swiss Quality

Made in Switzerland to ISO 9001/ISO 14001.

1 Marking

Type and part number.

2 Traceability

Lot number marking on all products for traceability through the entire manufacturing process.

3 Original REGO-FIX®

Original only with the REGO-FIX® quality seal \triangle . Guarantee for best quality.

T.I.R. of the Whole System <3 μ m

Highest clamping force and best runout in one.

Taper Accuracy AT3

Better spindle-to-holder fit and accuracy.

Surface Finish max. Ra 0.25

Higher clamping force and higher transferable torque.

Q+® Balancing

100% balanced to G 2.5 @ 22'000 min⁻¹.
Ideal for High Speed Cutting (HSC) and High Performance Cutting (HPC).

Hi-Q® Balancing System

Ready to accept Hi-Q® balancing rings which allow to offset the imbalance introduced by the cutting tool up to 80'000 min⁻¹.

Minimal Outside Dimensions

Slim design provides more processing flexibility.

Fast

Tool clamping with hydraulic press in less than 10 seconds.

Excellent at Small Diameters

Clamping of small diameter tools from \varnothing 0.2 mm.

Presetable Tooling System

Repeatability <10 μ m

ID Chip Hole

Per DIN 69873 with 10 mm diameter.

5

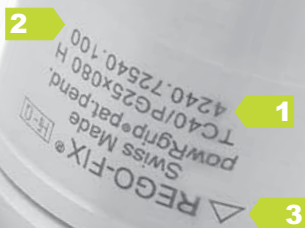

Information

DIN 69871

TC/PG Toolholder

Applications

These collets are designed for use on CNC-machining centers with automatic tool changers. They are especially suited for HSC and HPC operations where processing reaches the machine limits. The vibration dampening of TC/PG collets reduce spindle wear and extend tool life.

Balancing

REGO-FIX® Q+® System TC/PG collets are balanced to G 2.5 @ 22'000 min⁻¹. Type H collets are ready to accept Hi-Q® balancing rings which allow precision balancing of the system including cutting tool up to 80'000 min⁻¹ depending on the balancing rings used.

Coolant Through

For use with coolant through tools.

Peripheral Cooling

PG-CF collets for peripheral cooling with non-coolant through tools.

Matched Tooling System for Best Fit

For highest precision and best results the whole system counts. Therefore REGO-FIX® components are carefully matched to fit together. This guarantees best run-out and balancing.

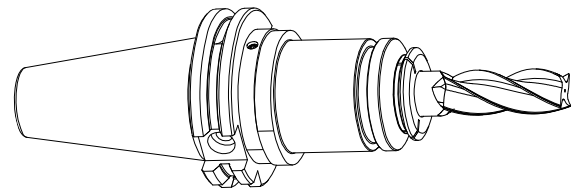

Matching Products

powRgrip® Collets

0.200 - 1.5875 mm powRgrip® collets with microbore (PG 10-MB) see page 2.36.

Ø [mm]	Ø [Inch]	Ø [Inch]	PG 10 Part No.	PG 10-CF Part No.	PG 15 Part No.	PG 15-CF Part No.	PG 25 Part No.	PG 25-CF Part No.	PG 32 Part No.	PG 32-CF Part No.
2.000	0.0787	-	1710.02000	-	-	-	-	-	-	-
2.500	0.0984	-	1710.02500	-	-	-	-	-	-	-
3.000	0.1181	-	1710.03000	1710.03002	1715.03000	1715.03002	1725.03000	1725.03002	-	-
3.175	0.1250	1/8"	1710.03181	1710.03183	1715.03181	1715.03183	1725.03181	1725.03183	-	-
3.500	0.1378	-	1710.03500	-	1715.03500	-	1725.03500	-	-	-
4.000	0.1575	-	1710.04000	1710.04002	1715.04000	1715.04002	1725.04000	1725.04002	-	-
4.500	0.1969	-	1710.04500	-	1715.04500	-	1725.04500	-	-	-
4.763	0.1875	3/16"	1710.04761	1710.04763	1715.04761	1715.04763	1725.04761	1725.04763	-	-
5.000	0.1969	-	1710.05000	1710.05002	1715.05000	1715.05002	1725.05000	1725.05002	-	-
5.500	0.2165	-	1710.05500	-	1715.05500	-	1725.05500	-	-	-
6.000	0.2362	-	1710.06000	1710.06002	1715.06000	1715.06002	1725.06000	1725.06002	1732.06000	1732.06002
6.350	0.2500	1/4"	1710.06351	1710.06353	1715.06351	1715.06353	1725.06351	1725.06353	1732.06351	1732.06353
7.000	0.2756	-	-	-	1715.07000	1715.07002	1725.07000	1725.07002	1732.07000	1732.07002
7.938	0.3125	5/16"	-	-	1715.07941	1715.07943	1725.07941	1725.07943	1732.07941	1732.07943
8.000	0.3150	-	-	-	1715.08000	1715.08002	1725.08000	1725.08002	1732.08000	1732.08002
9.000	0.3543	-	-	-	1715.09000	1715.09002	1725.09000	1725.09002	1732.09000	1732.09002
9.525	0.3750	3/8"	-	-	1715.09521	1715.09523	1725.09521	1725.09523	1732.09521	1732.09523
10.000	0.3937	-	-	-	1715.10000	1715.10002	1725.10000	1725.10002	1732.10000	1732.10002
11.000	0.4331	-	-	-	-	-	1725.11000	1725.11002	1732.11000	1732.11002
11.113	0.4375	7/16"	-	-	-	-	1725.11111	1725.11113	1732.11111	1732.11113
12.000	0.4724	-	-	-	-	-	1725.12000	1725.12002	1732.12000	1732.12002
12.700	0.5000	1/2"	-	-	-	-	1725.12701	1725.12703	1732.12701	1732.12703
13.000	0.5112	-	-	-	-	-	1725.13000	1725.13002	-	-
14.000	0.5512	-	-	-	-	-	1725.14000	1725.14002	1732.14000	1732.14002
14.288	0.5625	9/16"	-	-	-	-	1725.14291	1725.14293	1732.14291	1732.14293
15.000	0.5906	-	-	-	-	-	1725.15000	1725.15002	-	-
15.875	0.6250	5/8"	-	-	-	-	1725.15881	1725.15883	1732.15881	1732.15883
16.000	0.6300	-	-	-	-	-	1725.16000	1725.16002	1732.16000	1732.16002
18.000	0.7087	-	-	-	-	-	1725.18000	1725.18002	1732.18000	1732.18002
19.050	0.7500	3/4"	-	-	-	-	1725.19051	1725.19053	1732.19051	1732.19053
20.000	0.7874	-	-	-	-	-	1725.20000	1725.20002	1732.20000	1732.20002
22.000	0.8661	-	-	-	-	-	-	-	1732.22000	1732.22002
22.225	0.8750	7/8"	-	-	-	-	-	-	1732.22231	1732.22233
25.000	0.9843	-	-	-	-	-	-	-	1732.25000	1732.25002
25.400	1.0000	1"	-	-	-	-	-	-	1732.25401	1732.25403

powRgrip® clamping units and further powRgrip® accessories see page 12.7/12.8.

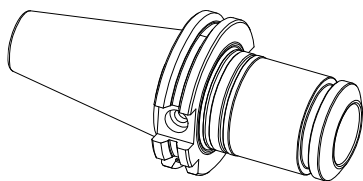

powRgrip® Colletholders | Balancing Rings

Type	Form A+AD Part No.	Form AD+B Part No.	D [mm]	L [mm]	Balancing Rings
TC 30 / PG 10 x 060*	2230.71020	-	16	60	-
TC 30 / PG 10 x 073 H	4230.71030	-	16	73	FWR 285
TC 30 / PG 15 x 060*	2230.71520	-	24	60	-
TC 30 / PG 15 x 080 H	4230.71540	-	24	80	FWR 285
TC 30 / PG 15 x 120 H	4230.71560	-	24	120	FWR 285
TC 30 / PG 25 x 080*	2230.72540	-	40	80	-
TC 30 / PG 25 x 160 H	4230.72580	-	40	160	FWR 405

TC 40 / PG 10 x 080 H	4240.71040	4240.71043	16	80	FWR 285
TC 40 / PG 10 x 120 H	4240.71060	4240.71063	16	120	FWR 285
TC 40 / PG 10 x 160 H	4240.71080	4240.71083	16	160	FWR 325
TC 40 / PG 15 x 072*	2240.71530	2240.71533	24	72	-
TC 40 / PG 15 x 080 H	4240.71540	4240.71543	24	80	FWR 285
TC 40 / PG 15 x 120 H	4240.71560	4240.71563	24	120	FWR 325
TC 40 / PG 15 x 160 H	4240.71580	4240.71583	24	160	FWR 325/285
TC 40 / PG 25 x 072*	2240.72530	2240.72533	40	72	-
TC 40 / PG 25 x 080 H	4240.72540	4240.72543	40	80	FWR 405
TC 40 / PG 25 x 120 H	4240.72560	4240.72563	40	120	FWR 405
TC 40 / PG 25 x 160 H	4240.72580	4240.72583	40	160	FWR 405/405
TC 40 / PG 32 x 080*	2240.73240	2240.73243	50	80	-

TC 50 / PG 25 x 081*	2250.72540	2250.72543	40	81	-
TC 50 / PG 25 x 100 H	4250.72550	4250.72553	40	100	FWR 505
TC 50 / PG 25 x 160 H	4250.72580	4250.72583	40	160	FWR 505/405
TC 50 / PG 25 x 200 H	4250.72590	4250.72593	40	200	FWR 505/405
TC 50 / PG 32 x 080*	2250.73240	2250.73243	50	80	-

*Not for use with balancing rings.

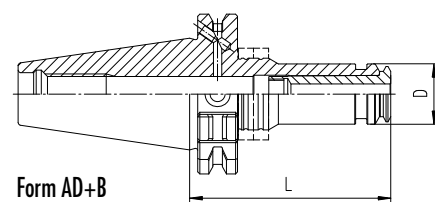
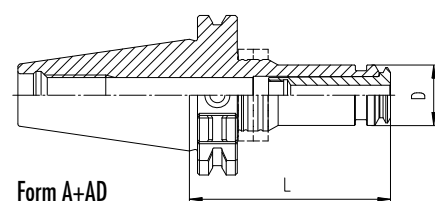

5

Hi-Q® Balancing Rings	Part No.	Page
Set FWR 225	7490.22500	12.9
Set FWR 285	7490.28500	12.9
Set FWR 325	7490.32500	12.9
Set FWR 405	7490.40500	12.9
Set FWR 505	7490.50500	12.9
Torque screwdriver (TSD)	7159.09000	12.9

Maximum rpm for Hi-Q balancing rings see page 12.9.

Drawings with detailed dimensions see

search.rego-fix.ch



Swiss
Precision
Tools

WD

Toolholders

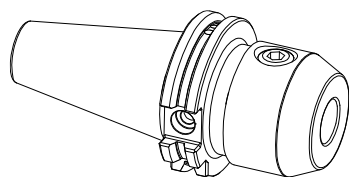

TC | WD
DIN 69871

End Mill Holders (WELDON)

Type	Form A+AD Part No.	d [mm]	D [mm]	L [mm]	Drawing
TC 40 / WD 6 x 050	2240.30620	6	25	50	1
TC 40 / WD 8 x 050	2240.30820	8	28	50	1
TC 40 / WD 10 x 050	2240.31020	10	35	50	1
TC 40 / WD 12 x 050	2240.31220	12	42	50	1
TC 40 / WD 14 x 050	2240.31420	14	44	50	1
TC 40 / WD 16 x 063	2240.31630	16	48	63	1
TC 40 / WD 18 x 063	2240.31830	18	50	63	1
TC 40 / WD 20 x 063	2240.32030	20	52	63	1
TC 40 / WD 25 x 100	2240.32560	25	65	100	2
TC 40 / WD 32 x 100	2240.33260	32	72	100	2

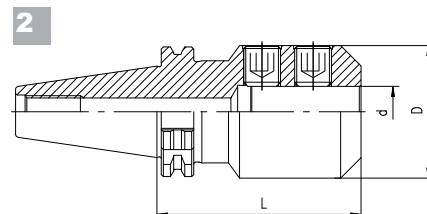
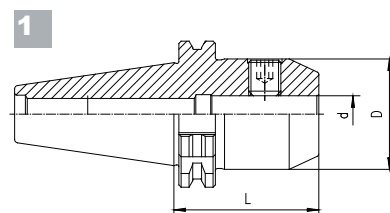

Drawings with detailed dimensions see

search.rego-fix.ch

Supplied with: End mill holder and lock screw.

5

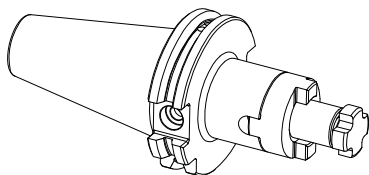

Universal Shell Mill | Face Mill Holders | Matching Spanners

Type	Form A Part No.	D [mm]	D1 [mm]	L [mm]	Drawing
TC 40 / KFD 16 x 055	2240.41630	16	32	55	1
TC 40 / KFD 22 x 055	2240.42230	22	40	55	1
TC 40 / KFD 27 x 055	2240.42730	27	48	55	1
TC 40 / KFD 32 x 060	2240.43240	32	58	60	2
TC 40 / KFD 40 x 060	2240.44040	40	70	60	2

TC 50 / KFD 16 x 055	2250.41630	16	32	55	1
TC 50 / KFD 22 x 055	2250.42230	22	40	55	1
TC 50 / KFD 27 x 055	2250.42730	27	48	55	1
TC 50 / KFD 32 x 055	2250.43230	32	58	55	1
TC 50 / KFD 40 x 055	2250.44030	40	70	55	1
TC 50 / KFD 50 x 070	2250.45050	50	90	70	2

Supplied with:
Universal shell mill/face mill holder, lock screw, feather key and drive ring.

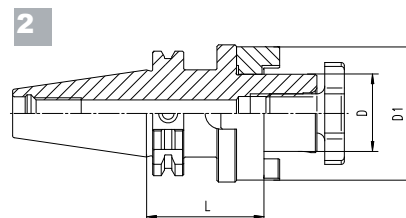
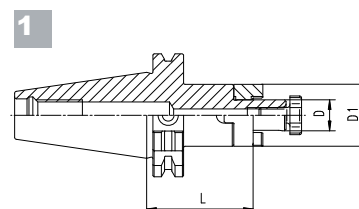

5

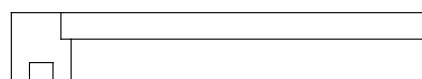

Matching Spanners Type	Part No.
FDS 16	7711.16000
FDS 22	7711.22000
FDS 27	7711.27000
FDS 32	7711.32000
FDS 40	7711.40000
FDS 50	7711.50000

Drawings with detailed dimensions see

search.rego-fix.ch



Swiss
Precision
Tools

KBF

Toolholders

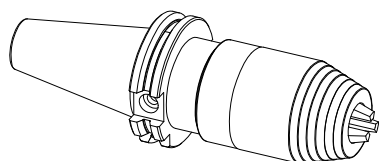

TC | KBF
DIN 69871

Drill Chucks

Type	Form A Part No.	Form AD+B Part No.	d [mm]	D [mm]	L [mm]
TC 30 / KBF 1-13 mm	2230.50100	-	1-13	50	111
TC 40 / KBF 1-13 mm	-	2240.50103	1-13	50	90
TC 50 / KBF 1-13 mm	-	2250.50103	1-13	50	106

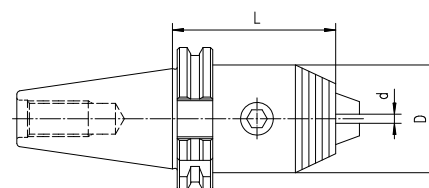

5

Supplied with: Drill chuck and allen-key.

Clamping range	1-13 mm
Maximum runout difference	0.03 mm
Maximum tightening torque	20 Nm
Clamping force (@ 20 Nm tightening torque)	80 Nm
Maximum rpm	up to 35'000 min ⁻¹

Drawings with detailed dimensions see

search.rego-fix.ch

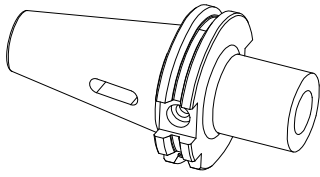

TC | MK
DIN 69871

Morse Taper Holder

Type	Form A+AD Part No.	D [mm]	L [mm]
TC 40 / MK 1 x 050	2240.80110	25	50
TC 40 / MK 2 x 050	2240.80210	32	50
TC 40 / MK 3 x 070	2240.80320	40	70
TC 40 / MK 4 x 095	2240.80430	48	95

Supplied with: Morse taper holder.

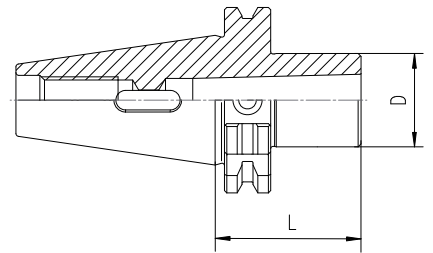

5

Drawings with detailed dimensions see

search.rego-fix.ch