

# BT NÁSTRČNÉ upínače s BT stopkou

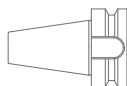

TYP ODLEHČENÍ

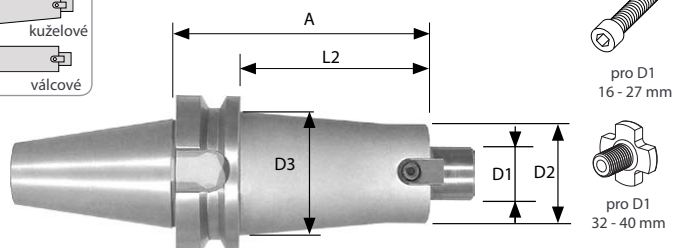
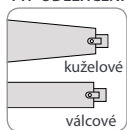

NOVINKA

BT 40						
D1 (mm)	L2 (mm)	D2 (mm)	D3 (mm)	A (mm)	JET	
					Objednáací číslo	
16	25	35	35	52	972-BT401625	
	50	35	42	77	972-BT401650	
	75	35	45	102	972-BT401675	
	100	35	50	127	972-BT4016100	
	150	35	50	177	972-BT4016150	
	200	35	50	227	972-BT4016200	
22	25	40	40	52	972-BT402225	
	50	40	45	77	972-BT402250	
	75	40	50	102	972-BT402275	
	100	40	50	127	972-BT4022100	
	150	40	50	177	972-BT4022150	
	200	40	50	227	972-BT4022200	
27	25	45	45	52	972-BT402725	
	50	45	45	77	972-BT402750	
	75	45	45	102	972-BT402775	
	100	45	45	127	972-BT4027100	

BT 50								
D1 (mm)	L2 (mm)	D2 (mm)	D3 (mm)	A (mm)	Bez chlazení		JET	
					Objednáací číslo		Objednáací číslo	
16	50	35	40	88	-		972-BT501650	
	100	35	50	138	-		972-BT5016100	
	150	35	53	188	972-BT5016150		-	
	200	35	60	238	972-BT5016200		-	
22	50	40	40	88	-		972-BT502250	
	100	40	50	138	-		972-BT5022100	
	150	40	62	188	972-BT5022150		-	
	200	40	68	238	972-BT5022200		-	
27	20	60	60	58	-		972-BT502720	
	50	60	60	88	-		972-BT502750	
	100	60	70	138	-		972-BT5027100	
	150	60	78	188	972-BT5027150		-	
32	200	60	78	238	972-BT5027200		-	
	50	70	70	88	972-BT503250		-	
	100	70	95	138	972-BT5032100		-	
	150	70	95	188	972-BT5032150		-	
40	50	95	95	88	972-BT504050		-	
	100	95	95	138	972-BT5040100		-	

Vyváženo: G6,3 / 8000

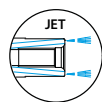

TYP ODLEHČENÍ

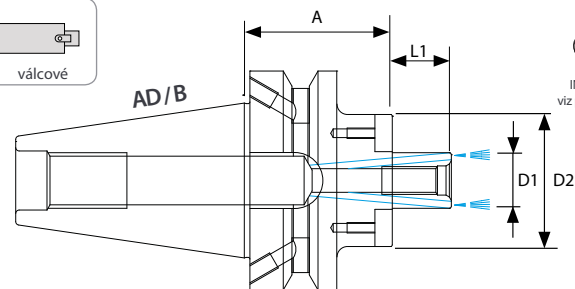
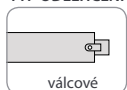

BT 40						
	D1 (mm)	A (mm)	D2 (mm)	L1 (mm)	JET	
					Objednáací číslo	
Krátké	16	35	38	17	7540051-01	
	22	35	48	19	7540051-02	
	27	35	60	21	7540051-03	
	32	50	78	24	7540051-04	
	40	50	89	27	7540051-05	
A=100mm	16	100	38	17	7540051-31	
	22	100	48	19	7540051-32	
	27	100	60	21	7540051-33	
	32	100	78	24	7540051-34	

BT 50						
	D1 (mm)	A (mm)	D2 (mm)	L1 (mm)	JET	
					Objednáací číslo	
Krátké	22	55	48	19	7550051-02	
	27	55	60	21	7550051-03	
	32	55	78	24	7550051-04	
	40	55	89	27	7550051-05	
A=100mm	22	100	48	19	7550051-32	
	27	100	60	21	7550051-33	
	32	100	78	24	7550051-34	

Jemně vyváženo: G2,5 / 25 000 nebo U < 1gmm

# Upínací čepy

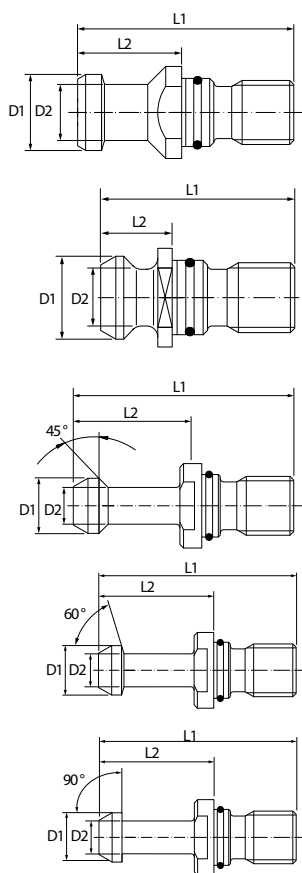

	Stopka	Závit	Úhel	Průchozí	Slepý	D1 (mm)	D2 (mm)	L1 (mm)	L2 (mm)	Objednací číslo
DIN 69872	SK 40	M16	-	✓	✓	19	14	54	26	DIN69872-SK40-P
										DIN69872-SK40-S
DIN 69872	SK 50	M24	-	✓	✓	28	21	74	34	DIN69872-SK50-P
										DIN69872-SK50-S
ISO 7388 - B	SK 40	M16	-	✓	✓	18,95	12,95	44,5	16,4	ISO7388-SK40-P
										ISO7388-SK40-S
ISO 7388 - B	SK 50	M24	-	✓	✓	29,1	19,6	65,5	25,5	ISO7388-SK50-P
										ISO7388-SK50-S
MAS-BT	BT 40	M16	45°	✓		15	10	60	35	MASBT-BT40-45-P
			45°		✓					MASBT-BT40-45-S
			60°	✓						MASBT-BT40-60-P
			60°		✓					MASBT-BT40-60-S
			90°	✓						MASBT-BT40-90-P
	90°		✓	MASBT-BT40-90-S						
	BT 50	M24	45°	✓		23	17	85	45	MASBT-BT50-45-P
			45°		✓					MASBT-BT50-45-S
			60°	✓						MASBT-BT50-60-P
			60°		✓					MASBT-BT50-60-S
90°			✓		MASBT-BT50-90-P					
90°		✓	MASBT-BT50-90-S							

# Upínací šrouby, klíče a chladicí trubičky

## KŘÍŽOVÉ šrouby

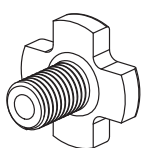

Objednací číslo	Pro ø D1 (mm)	Závit (mm)
225-03	16	M8
225-04	22	M10
225-05	27	M12
225-06	32	M16
225-07	40	M20

## INBUS šrouby

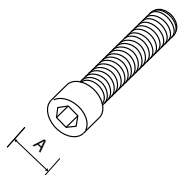

Objednací číslo	Pro ø D1 (mm)	Závit (mm)	A (mm)
957-M8	16	M8	12,9
M-1035-HS	22	M10	14,0
957-M10		M10	15,9
957-M12	27	M12	17,9

## Upínací klíče ke KŘÍŽOVÝM šroubům

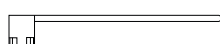

Objednací číslo	Pro ø D1 (mm)
DIN 6368-16	16
DIN 6368-22	22
DIN 6368-27	27
DIN 6368-32	32
DIN 6368-40	40

## CHLADÍČÍ TRUBIČKY pro HSK upínače



Typ upínače	Objednací číslo
HSK-A32 (HSK-E32, HSK-F40)	CT-HSK-A32
HSK-A40 (HSK-E40, HSK-F50)	CT-HSK-A40
HSK-A50 (HSK-E50, HSK-F63)	CT-HSK-A50
HSK-A63 (HSK-E63, HSK-F80)	CT-HSK-A63
HSK-A80 (HSK-E80)	CT-HSK-A80
HSK-A100 (HSK-E100)	CT-HSK-A100
HSK-A125 (HSK-E125)	CT-HSK-A125

## KLÍČE pro chladicí trubičky pro HSK upínače



Typ upínače	Objednací číslo
HSK-A32 (HSK-E32, HSK-F40)	KCT-HSK-A32
HSK-A40 (HSK-E40, HSK-F50)	KCT-HSK-A40
HSK-A50 (HSK-E50, HSK-F63)	KCT-HSK-A50
HSK-A63 (HSK-E63, HSK-F80)	KCT-HSK-A63
HSK-A80 (HSK-E80)	KCT-HSK-A80
HSK-A100 (HSK-E100)	KCT-HSK-A100